

\$785,857

Lot 10

Sandpiper Park Estate

Pelican Drive Bargara, QLD 4670

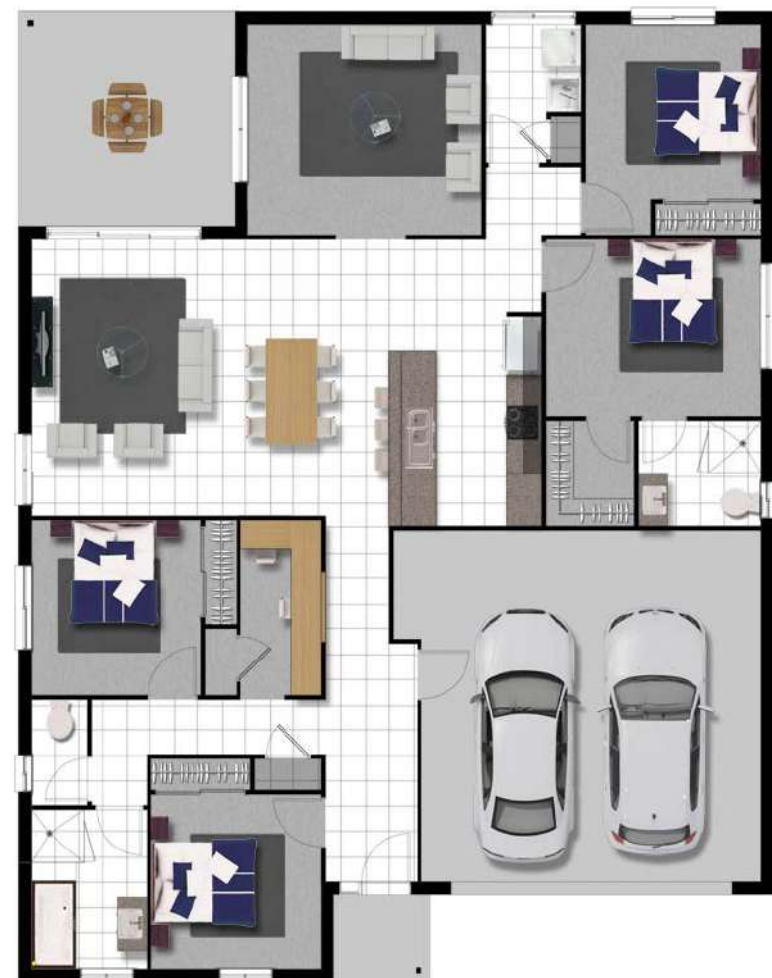

BRIBIE 205



4 2 2 2

| | |
|--------------------|----------------------------|
| Living Area | 149.5 m ² |
| Garage Area | 37.87 m ² |
| Alfresco Area | 14.36 m ² |
| Porch Area | 3.51 m ² |
| Total Area | 205.0 m² |
| Build Price | \$473,057 |

| | |
|-------------------|---------------------|
| Land Area | 712.0m ² |
| Land Registration | 1/9/25 |
| Land Price | \$312,800 |

Featured Inclusions

- 2550mm Ceiling Height Square Set
- 2 x Split System Air Con Units
- 20mm Stone benchtops in Kitchen & Bathrooms
- Pendant Lights to Kitchen Island Bench (2)
- Soft Close Draws & Doors to Kitchen, Bathroom & Ensuite
- Niches to Bathroom & Ensuite Showers
- Semi Frameless Shower Screens
- Landscaping & Fencing
- Mirrored Wardrobe Doors & Bank of Shelves to Bedrooms
- Wall Hung Vanities